

Hardware Configuration - Configuring a Digital Sensor

- In Config Menu, Select “Digital Devices”
- Select Port Number and Name Sensor (no Whitespace)

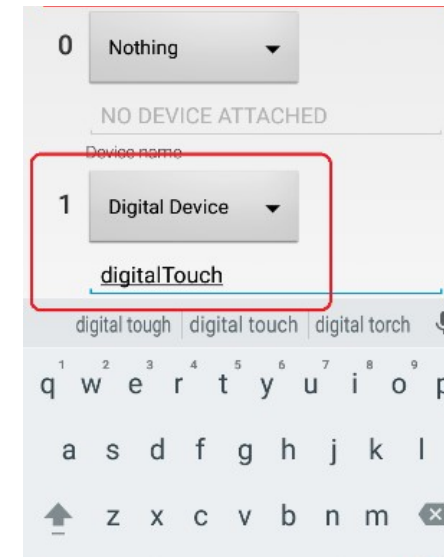

Select sensor type and name it.

Hardware Configuration - Configuring a Digital Sensor

- In Config Menu, Select “Digital Devices”
- Select Port Number and Name Sensor (no Whitespace)
- Hit “Done”

Active Configuration: (unsaved) <No Config Set>

Done Cancel

Port	Attached
0	Nothing
NO DEVICE ATTACHED	
Device name	
1	Digital Device
digitalTouch	
Device name	
2	Nothing
NO DEVICE ATTACHED	

Hit “Done”

Hardware Configuration - Configuring an Analog Sensor

- In Config Menu, Select “Analog Input Devices”
- Select Port Number and Name Analog Sensor (no Whitespace)
- Hit “Done”

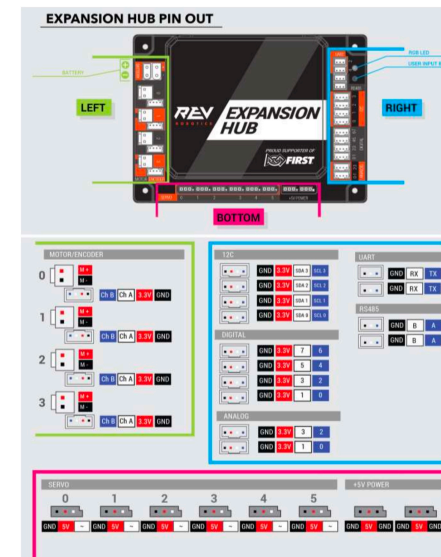

Configuring an Analog sensor is going to be exactly the same as a digital sensor, only you're going to choose Analog instead of Digital.

Hardware Configuration - Saving Config Info

- After Hardware is Configured, Hit “Done”

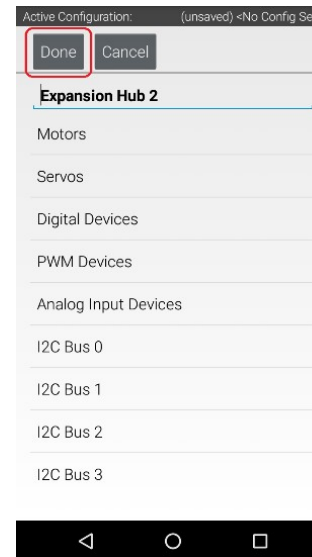

Once you have your hardware mapped in the config file, go ahead and save the config file. Hit “done”

Hardware Configuration - Saving Config Info

- After Hardware is Configured, Hit “Done”
- Press “Done” Again

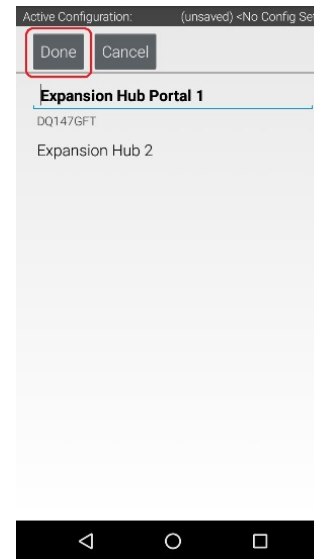

then hit it again...

Hardware Configuration - Saving Config Info

- After Hardware is Configured, Hit “Done”
- Press “Done” Again
- Press “Save”

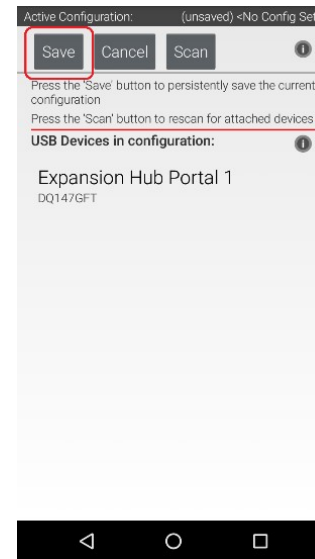

then hit save....

Hardware Configuration - Saving Config Info

- After Hardware is Configured, Hit “Done”
- Press “Done” Again
- Press “Save”
- Name Config File and Hit “OK”

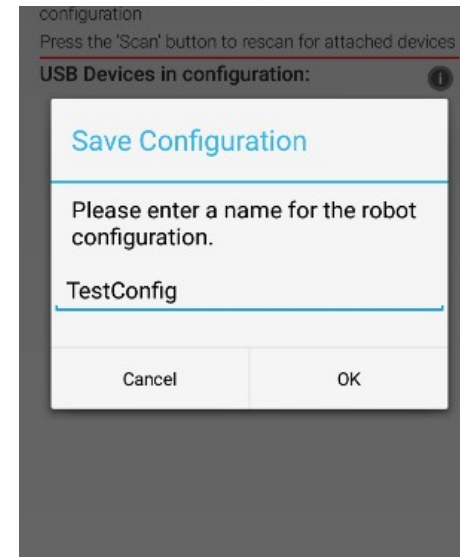

Name the config file

Hardware Configuration - Saving Config Info

- After Hardware is Configured, Hit “Done”
- Press “Done” Again
- Press “Save”
- Name Config File and Save

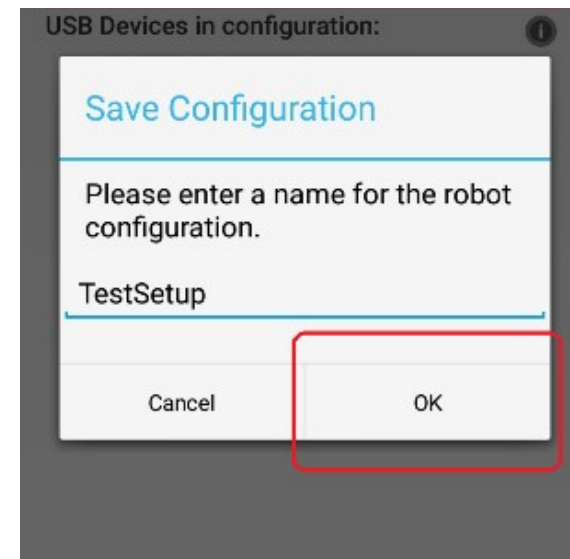

and press “ok”

Hardware Configuration - Saving Config Info

- After Hardware is Configured, Hit “Done”
- Press “Done” Again
- Press “Save”
- Name Config File and Save
- Verify that Config File is Active
 - Hit “Back Button”

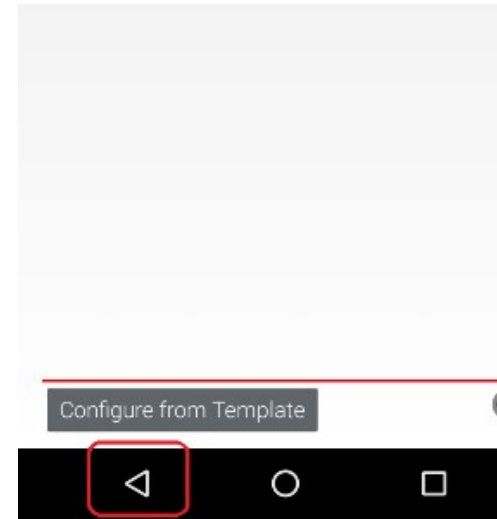

Now you need to verify that the phone is using your config file as the active one. Because you only have one right now, it should, but once you begin to have multiple config files, this will become much more important. To verify that the correct config file is active, hit the back button.

Hardware Configuration - Saving Config Info

- After Hardware is Configured, Hit “Done”
- Press “Done” Again
- Press “Save”
- Name Config File and Save
- Verify that Config File is Active
 - Hit “Back Button”
 - Verify That Your Config File is the Active Config File

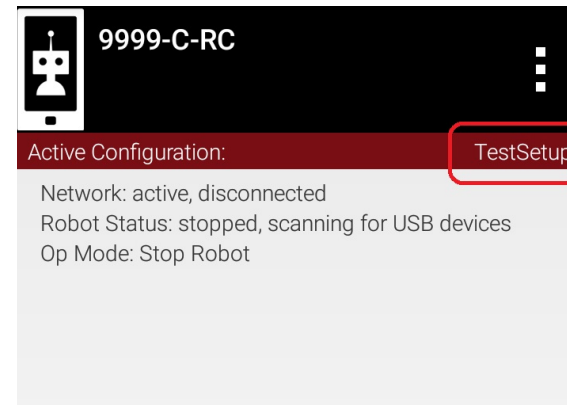

Then look at the red bar near the top. It says “Active Configuration” on the left and the name of the active config file on the right. If it is displaying your config file, then you are good to go.

Does anyone have any questions?